

# Gas spring G 06-19

<b>Extension force F1</b>	40 - 400 Newton
<b>Progression</b>	17 %
<b>Piston rod</b>	Ø 6 mm, steel, hard chrome plated
<b>Cylinder</b>	Ø 19 mm, steel, black spray coated
<b>Threads</b>	Steel zinc plated

GZ 10

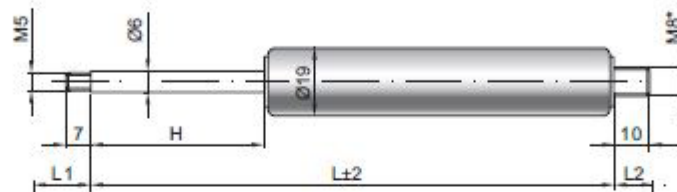

GZ 10

AU 16

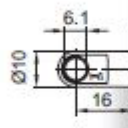

### Details

#### Standard strokes H (mm)

20, 30, 40, 50, 60, 70, 80, 100, 110,  
120, 140, 150, 160, 170, 180, 190, 200,  
220, 250, 300

#### Standard length GL

$L = 2 \times H + 55$   
 $GL = L + L1 + L2$

#### Extras

- 2 - Radial valve
- 4 - Grease chamber
- 5 - Valve
- 6 - Protection tube
- 7 - Floating piston
- B3 - Sealing system
- NT - Low-temperature design
- HT - High-temperature design
- RK - Friction element

More **threads** can be found here [▶](#)

Matching **brackets** can be found here [▶](#)

AB 11

only possible on cylinder end

AS 20

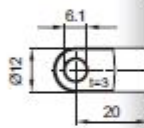

AU 19

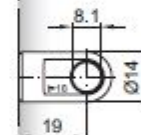

AR 16

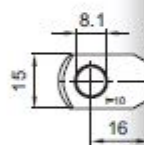

WG 18

until max. 800 N

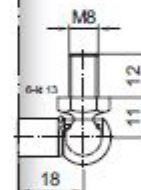

AG 27

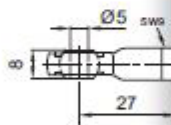

GA 32

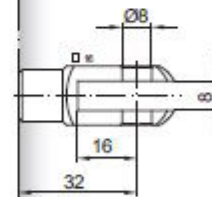

GA 20

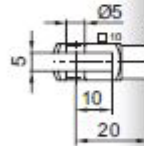

QV GZ

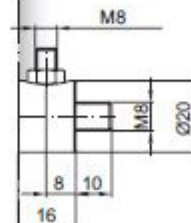
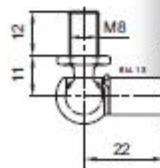

WX 22